

Laying instructions for parquet with Top Connect®

Please read carefully from beginning to end before installing the floor!!

Please always comply with the laying instructions that are enclosed with the cartons. These instructions are binding!

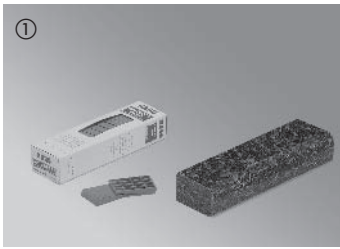

Laying tools: tapping block, wedges, pencil, saw, and maybe the unlocking help system.



Always use 0.2 mm thick PE film as an underlay when laying your floor over floor screed. The overlap seams must overlap by 30 cm. Extend underlay up all walls. After having installed the skirtings cut underlay at the upper edge of the skirtings.



For sound insulation and to smooth out slight irregularities of the subfloor, unroll 2 mm thick Silent Luxury insulation underlay. Do not overlap. Our range of accessories also offers suitable insulation underlays. Asphaltbitumen felt is not suitable for sound insulation. **Parquet with integrated insulation layer is not suitable for glue-down installation.**

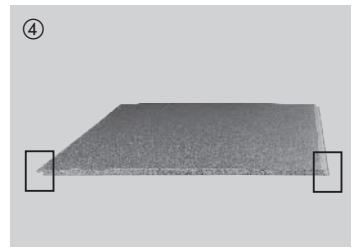

Cross section of long side
Tongue side / Groove side



Starting in the right-hand corner of the room, align the boards of the first row with the tongue side parallel to the wall, and fix them in place with wall spacers or plastic spacers as you proceed (always keep an expansion gap of 10 - 15 mm (3/8" - 1/2") around perimeter).



Proceed board by board to complete the first row: Angle the short side of next board into the board on its left. Briefly push down the left-hand side of the board to interlock the two boards. It is important to ensure that the first row is straight and exactly parallel to the wall. Cut the last board of the first row to size, leaving an expansion gap of 10-15 mm (3/8" - 1/2") between the board and wall. Fit in the board.



Start the second row with the leftover piece of the first row (offset the end joints of adjoining rows by at least 50 cm). This considerably reduces waste. Proceed board by board to install the remaining boards. First, the element is angled into the previous row along the long side by applying a small amount of force.



Use a hammer and tapping block as required.



Then rotate the board down. Ensure that the short side of the board is flush with the board on its left. Briefly push down the left-hand end of the board to interlock the two boards.

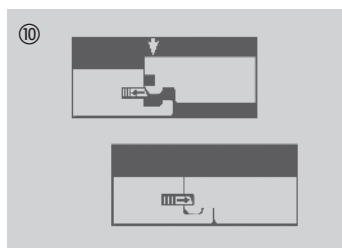

Cross section of short side
Locking system



Cut to size and fit in the boards of the last row. Leave a gap of 10 to 15 mm between the boards and wall.

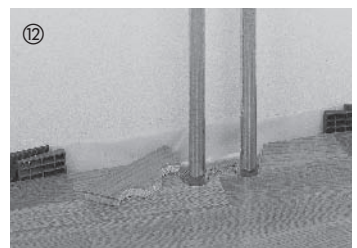

If radiator pipes protrude from the floor, drill and saw a cutout into the board (the size of the cutout depends on the radiator pipe and the required expansion space).



In doorways, mount a suitable moulding system to ensure the necessary expansion space. This also applies if the same floor is to be laid in the adjoining room. In this case, a transition moulding should be used for covering the required expansion gap. Leave an expansion space of approx. 5 mm between the board and the base of the moulding. As a rule, a fine saw must be used to cut a gap the thickness of a board in wooden door frames to allow the parquet to expand.

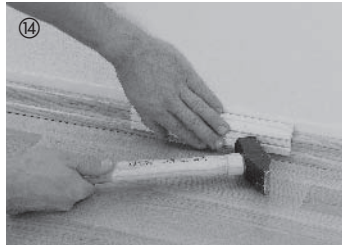

Be sure to remove all distance spacers once all boards are laid. Fasten skirtings (with or without clip system) to the walls – that's it.

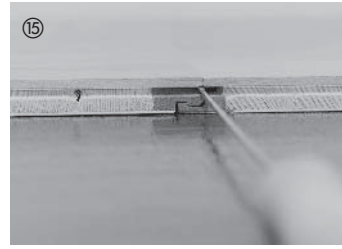

Tips for the unlocking of Top Connect: Remove the boards with the unlocking help system. Starting from the long grooved side, insert the dismantle tool into the groove of the short side.

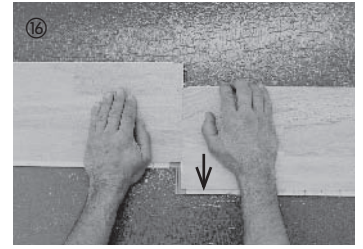

If the unlocking help system is not available, the boards can be pushed apart in a parallel direction.

General information

Please read carefully from beginning to end before installing the floor!!

Measures to take before installation

Do not open the cartons prior to installation. Store and acclimatise the unopened cartons inside. New constructions to be closed in with air conditioning or heating units during the winter months. Recommended room conditions for installation are 18 °C (65 °F).

Important: Prior to installation, inspect the boards in daylight for any visible faults or damage and also check colour and texture. To achieve a regular distribution of the grade in the installed floor, we recommend installing from different packs at the same time. No claims are accepted once flooring boards have been installed. Elastic and textile floor coverings must be removed completely before installation.

Installation direction

The direction of laying normally depends on the main source of light fall in the room, e.g. French windows. The boards should run parallel with the entering light for best appearance. However, the proportions of the room can also be emphasised by skilled selection of the direction in which your parquet is laid. Light-coloured wood makes small rooms appear larger. With floating installation in large areas over 10 m (33 ft.) in length or width, an expansion joint must be allowed for. Apply an expansion moulding or cover strip over said expansion joint.

- Ensure that the boards are always laid lengthways in narrow hallways.
- When installing T, L or U-shaped areas, separate the flooring areas according to the room layout by using a suitable profile system.

In commercial/ public areas, we recommend glue-down installation. Please ask your dealer for our special laying instructions for glue-down installation. Parquet with integrated insulation layer is not suitable for glue-down installation.

Moisture check

The subfloor must be checked in a workmanlike manner by using a suitable measuring instrument (CM meter) in order to verify compliance with the required limit moisture content for laying the floor covering.

Limit moisture content without underfloor heating: Cement floors ≤ 2.0 CM (weight)%; anhydrite or anhydrite cast floors ≤ 0.5 CM (weight)%

Limit moisture content with underfloor heating: Cement floors ≤ 1.8 CM (weight)%; anhydrite or anhydrite cast floors ≤ 0.3 CM (weight)%

Please observe the preparatory measures which you find on our web site and in the "Installation over Underfloor Heating" section of these Laying Instructions. Prior to installation, a signed Record of Preparatory Subfloor Heat-Up Phase must be submitted by the client.

Installation over underfloor heating

When installing your floor over underfloor heating, the screed must be laid in accordance with the German DIN 1853 standard. Before you start laying your parquet floor, please verify that the underfloor heating system has been installed in compliance with DIN EN 1264 and DIN 4725 and that the proper preparatory heat-up phase has been completed. Detailed instructions on installation over underfloor heating can be obtained from your dealer.

Care:

Detailed instructions on care can be found in the HARO Floor Care Guide which you can obtain from your dealer.

Varnished parquet:

First care: Immediately after laying your new floor, you should carry out the first treatment with Secura-A. Secura-A significantly reduces the absorption of water during damp mopping and protects the seams and surface against penetrating moisture. To ensure a long lifetime of your floor, we recommend routine treatment with Secura-A once a year for intensive care.

Dry cleaning: It is usually absolutely sufficient to clean parquet flooring dry using a dust mop, soft broom or vacuum cleaner.

Damp cleaning/Care: We recommend damp mopping your floor surface regularly with Polish diluted in water. Cleaning frequency depends here on the wear and tear your floor is subjected to.

Intensive cleaning: To remove major soiling and ingrained dirt, you can use Basic Cleaner for regular intensive cleaning. Treat the floor with polish after each basic cleaning.

Parquet with oiled/waxed surface:

First care: First treatment immediately after laying your floor is not necessary. We recommend, however, to treat your floor with special care during the first week after installation. If heavy traffic and loads on your floor cannot be avoided, it is a good idea to temporarily cover the floor with cardboard or corrugated cardboard. Please only cover the floor for as long as absolutely necessary.

Dry cleaning: It is generally sufficient to clean your parquet with oiled/waxed surface dry using a mop, soft broom or vacuum cleaner.

Damp cleaning: We recommend damp mopping your surface regularly with Topfit diluted in water. Cleaning frequency depends here on the wear and tear your floor is subjected to.

Care: For routine care of your parquet with oiled/waxed finish, you should use Oil Balm. Again, the frequency depends on the wear and tear your floor is exposed to. Oil Balm is an easy-to-use, mild-smelling oil-wax combination based on sunflower oil, thistle oil and carnauba wax. You should do this whenever noticeable impairments appear on your floor as a result of heavy wear and tear.

Renovation: Parquet with oiled/waxed surface can be easily repaired in sections. Scratches, small burn marks and even paint stains can be remedied with Oil Balm.

Please note: Always wring out the cloth or mop very well before wiping the floor. Do not wet mop the parquet surface and never leave puddles or standing water! Steam cleaning machines are not suitable for cleaning parquet.

Room climate

What is good for people is also good for the high-grade woods of parquet. At a room temperature of 20° C (68 °F), a relative humidity of about 50–60 % is felt to be pleasant. In order to keep the air humidity constant, especially during hot periods, we recommend you use a humidifier. This will prevent any extreme drying out of the floor. Air humidifiers should be used right from the beginning of the heating season. If air humidity falls below normal values, small gaps may appear, which generally close again after the heating period.

Additional protection for your floor:

To preserve the quality and beauty of your parquet we recommend using protective pads under chairs and furniture legs. Chair castors and office roller chairs must comply with German Standard DIN 68131. Use only lined rollers of type W (soft). It is also a good idea to use polycarbonate mats as underlay for armchairs and office chairs.

04/09 Subject to modification in the interest of technical development.